

RoHS

受控

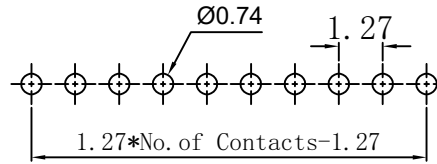

PCB LAYOUT

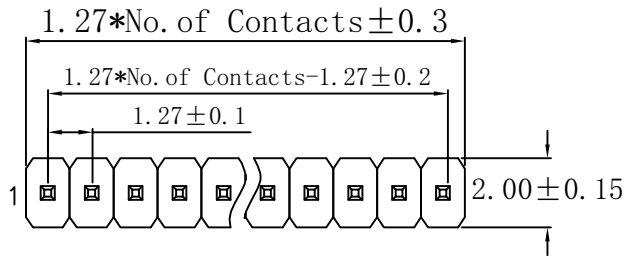
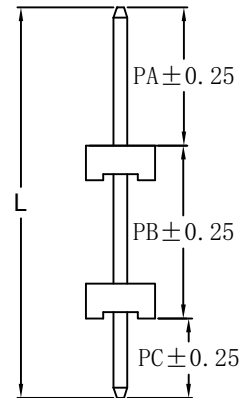
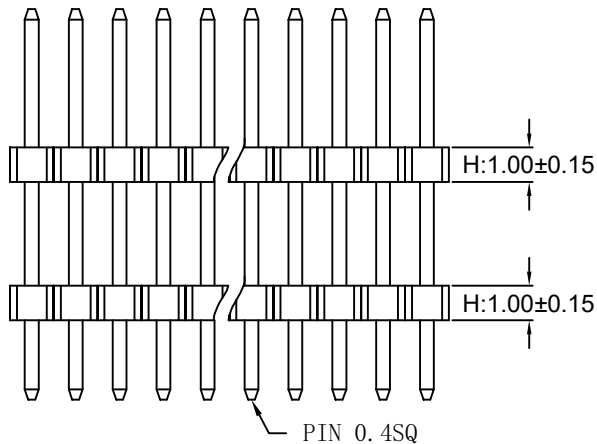

SPECIFICATION:

- Current Rating: 1A AC/DC
- Contact resistance: 20mΩ(Max).
- Insulation Resistance: 1000MΩ Min
- Withstanding Voltage: 500VAC(1Min)
- Operation Temperature: -40°C to +105°C
- Max Processing Temp: 230°C-260°C for 30°C-60°C seconds
- Material:
- Insulator : Glass filled PA6T (UL94V-0), black
- Contacts: Brass

Ordering Information

PH127DH100 ST- 1xx G A 0 301

Insulator height 100=1.00mm
 No. of Pins 120=1X20PIN
 Plating G=Gold Plated T=Tin Plated G2=Gold 2u" G10=Gold 10u"
 Material A=PA6T
 Package 0=PE Bag 1=Tape&Reel 2=Tube 3=Tray

Dimension antitheses list				
ITEM	PA	PB	PC	L
Alternate	3.90	5.00	2.30	11.20

SCONДАР ELECTRONIC LTD
ENGINEER LIU APPROVED

REV	DATE	MODIFICATION DESCRIPTION	CHANGE	APPROVE	OPERATION	DRAW	SCALE	UNIT	SHEET	PROJ.	TITLE:
AO	2021.5.17	NEW			X.X	Yang	—	mm	1/1		PH127DH100ST-1xxGA0301
					X.XX	Lyao		A4			PH1.27 ST DH1.0 PA3.9 PB5.0 PC2.3 L11.2 Gold flash PA6T 1XXP Pin header
					X.XXX	Lisa					
					Angle						
					DIM						

SCONДАР ELECTRONIC LIMITED