

RoHS

受控

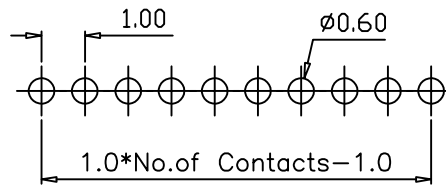
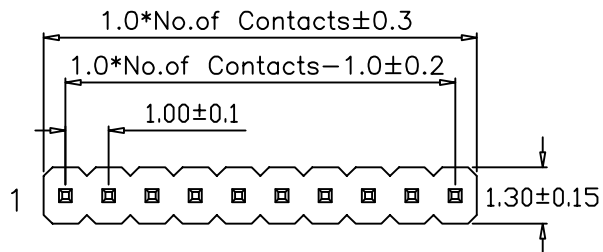

PCB LAYOUT

Specification:

- Current Rating: 1A AC/DC
- Contact resistance: 20mΩ(Max).
- Insulation Resistance: 1000MΩ Min
- Withstanding Voltage: 500VAC(1Min)
- Operation Temperature: -40°C to +105°C
- Max Processing Temp: 230°C-260°C for 30°C-60°C seconds
- Material:
- Insulator : Glass filled PA6T (UL94V-0), black
- Contacts: Brass

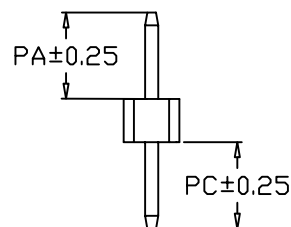
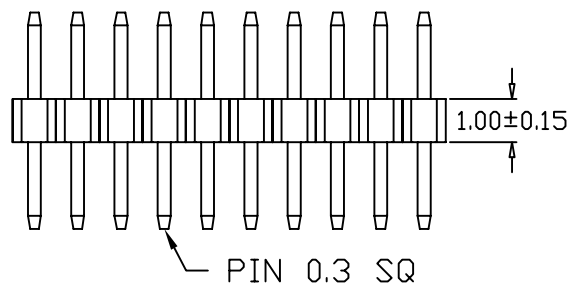

Ordering Information

PH100H100 ST- 1xx G A 0 301

Insulator height
100=1.00mm

No. of Pins
20=20PIN

Plating
G=Gold Plated
T=Tin Plated
G2=Gold 2u"
G10=Gold 10u"

Material
A=PA6T

Package
0=PE Bag
1=Tape&Reel
2=Tube
3=Tray

Dimension antitheses list

ITEM	PA	PC	L
Alternate	2.00	2.00	5.00

SCONDAR ELECTRONIC LTD
ENGINEER LIJI APPROVED

OPERATION

X.X ±0.35

X.XX ±0.25

X.XXX ±0.15

Angle ± 3'

DIM TOL

DRAW

DESIGN

CHECK

APPROVE

Yang

Lisa

2017.5.13

2017.5.15

SCALE

UNIT

SIZE

SHEET

PROJ.

-

mm

A4

1/1

⌀



SCONDAR ELECTRONIC LIMITED

PART NO.

TITLE:

PH100H100ST-1xxGA0301

PH1.0 ST H1.0 PA2.0 PC2.0 L5.0 Gold flash PA6T 1XXP Pin header

REV	DATE	MODIFICATION DESCRIPTION	CHANGE	APPROVE	OPERATION	DRAW	SCALE	UNIT	SIZE	SHEET	PROJ.	TITLE:
AO	2017.5.15	NEW			X.XX ±0.25	Yang	2017.5.13	mm	A4	1/1	⌀	PH100H100ST-1xxGA0301
					Angle ± 3'	Lisa	2017.5.15					PH1.0 ST H1.0 PA2.0 PC2.0 L5.0 Gold flash PA6T 1XXP Pin header