

RoHS

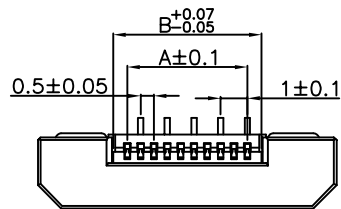

4-10PIN

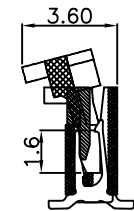
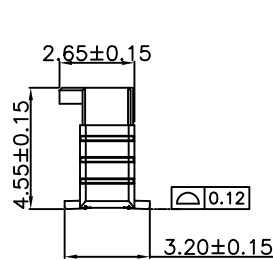
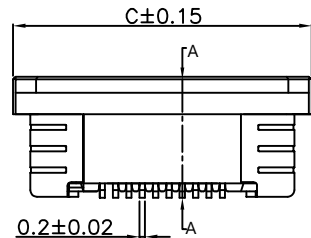

SECTION A-A

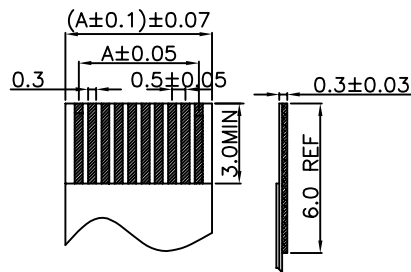
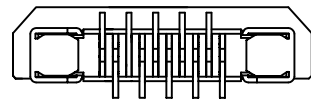

APPLICABLE FPC

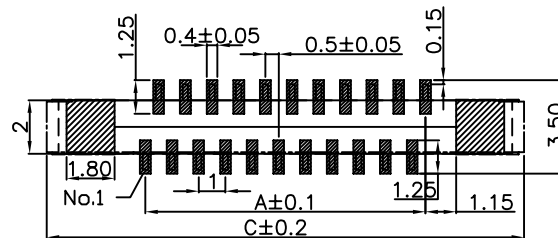

RECOMMENDED PCB LAYOUT

SPECIFICATION:

- Rated Current: 0.5A
- Rated voltage: 50V AC
- Insulation Resistance: 500MΩ Min
- Withstand voltage: 500VAC (1Min)
- Contact resistance: 30mΩ (Max)
- Working temperature: -25°C to +85°C

Material:

- Housing: LCP (UL94V-0) Beige
- Actuator: LCP (UL94V-0) Black
- Fitting Nail: Phosphor Bronze
- Plating: Surface nickel plating, followed by Tin plating
- Contact: Phosphor Bronze
- Plating: Surface nickel plating, followed by Tin plating

Ordering Information

FPC 05 20 A1 - xxP VS Z S 1 101

Pitch 05=0.5mm Height H=2.0mm Model No.of Pins See Table Type SMT WV Pin No1 Position Z=Positive F=Reverse Coating G=Gold S=Tin Package 1=Tap&Reel 2=Tube

PIN	Dim A	Dim B	Dim C
4	1.50	2.56	8.20
5	2.00	3.06	8.70
6	2.50	3.56	9.20
7	3.00	4.06	9.70
8	3.50	4.56	10.20
9	4.00	5.06	10.70
10	4.50	5.56	11.20

SCONDAR ELECTRONIC LTD
ENGINEER LIU APPROVED

OPERATION	DRAW	YAO	2021.03.03	SCALE	-
X.X ±0.35	DESIGN	LYAO	2021.03.06	UNIT	mm
X.XX ±0.25				SIZE	A4
X.XXX ±0.15				CHECK	Lisa
Angle ± 3'	APPROVE			PROJ.	⊕
DIM TOL				TITLE:	

SCONDAR
SCONDAR ELECTRONIC LIMITED

PART NO. FPC0520A1-XXPVSZS1101(4-10P)

FPC 0.5MM H=2.0 "A" MODEL POSITIVE-FOOT SMT VS LCP VO BEIGE XXP CONTACT TIN PLATING REEL PACKAGE

REV	DATE	MODIFICATION DESCRIPTION	CHANGE	APPROVE
AO	2021.03.11	NEW		