

RoHS

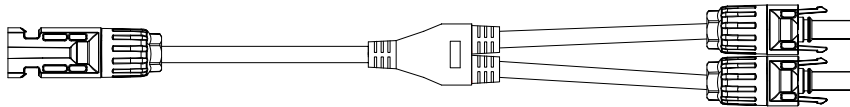
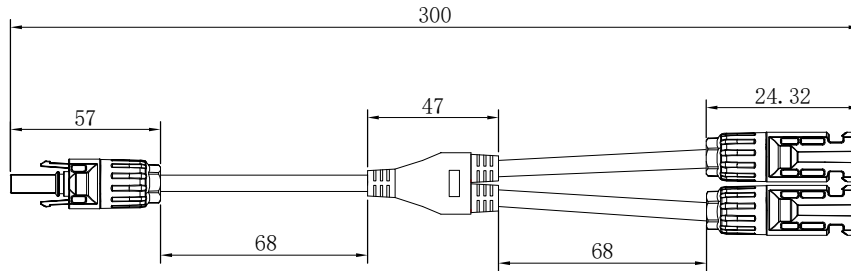

东莞市晟凯达电子科技有限公司
工程专用章

受控

Technical parameters:

- Rated voltage: 1000v
- Insulation material: ppo
- Conductor material: copper tin plating
- Ambient temperature: - 40° ~+95°
- Product temperature resistance: - 40° ~+135°
- Safety level: DCII
- Waterproof grade: IP68
- Contact resistance: <=0.5mΩ
- Connecting systems: multipoint connections
- Self locking system: embedded
- Wiring mode: crimping
- Wiring specification: 4mm²
- Rated current: 30A
- Flame retardant grade: UL94-V0
- Plastic unmarked tolerance: ±0.5

SCT PY - V1 30 3 01 641
 Y Type voltage current Entrance Shape Series
 V1=1000V 300=30A and exit
 3=3PASS

						OPERATION	DRAW	Yang	2020.05.03	SCALE	-	 SCONDAR ELECTRONIC LIMITED
						X.X ±0.35	DESIGN			UNIT	mm	
						X.XX ±0.25	CHECK	Lisa	2020.05.03	SIZE	A4	
AO	2020.03.03	NEW				X.XXX ±0.15	APPROVE			SHEET	1/1	
REV	DATE	MODIFICATION DESCRIPTION			CHANGE	APPROVE	Angle ± 3'			PROJ.	⌀	TITLE: PV through voltage: 1000V, current: 30A
						DIM TOL						