

RoHS

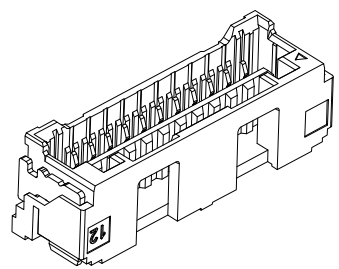

Specification:
 -Current Rating: 1.5A AC/DC
 -Voltage Rating: 100V AC/DC
 -Insulation Resistance: 100MΩ Min
 -Withstanding Voltage: 500VAC(1Min)
 -Contact resistance: 20mΩ(Max).
 -Operation Temperature: -25°C to +85°C
 Material:
 -Insulator (Housing): PA9T (UL94V-0)
 -Color: Beige
 -Contacts: Brass/Tin Plated

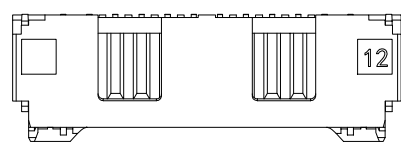
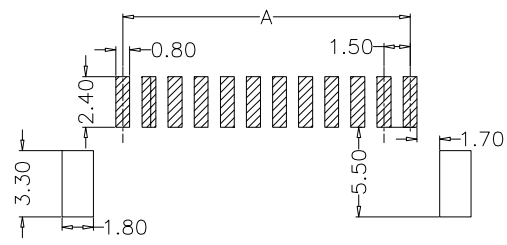
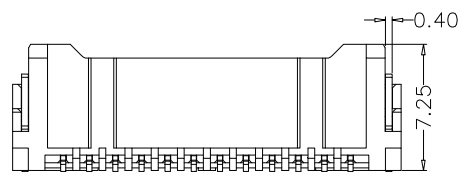
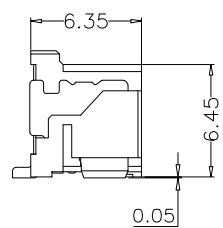
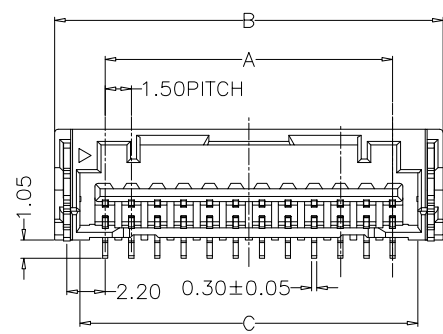

Ordering Information

SCT1503WVS - xx E 1 BE 113

No. of Pins See Table
 Insulation E=PA9T V0
 Package 1=Tape&Reel
 Color BE=Beige

Recommended P.C.B. Layout
 Total tolerance: ±0.05mm

Dimensions			Part NO	PIN
A	B	C		
1.50	7.30	4.40	SCT1503WVS-02E1BE113	2
3.00	8.80	5.90	SCT1503WVS-03E1BE113	3
4.50	10.30	7.40	SCT1503WVS-04E1BE113	4
6.00	11.80	8.90	SCT1503WVS-05E1BE113	5
7.50	13.30	10.40	SCT1503WVS-06E1BE113	6
9.00	14.80	11.90	SCT1503WVS-07E1BE113	7
10.50	16.30	13.40	SCT1503WVS-08E1BE113	8
12.00	17.80	14.90	SCT1503WVS-09E1BE113	9
13.50	19.30	16.40	SCT1503WVS-10E1BE113	10
15.00	20.80	17.90	SCT1503WVS-11E1BE113	11
16.50	22.30	19.40	SCT1503WVS-12E1BE113	12
18.00	23.80	20.90	SCT1503WVS-13E1BE113	13
19.50	25.30	22.40	SCT1503WVS-14E1BE113	14
21.00	26.80	23.90	SCT1503WVS-15E1BE113	15

2-5P

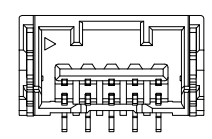

6-15P

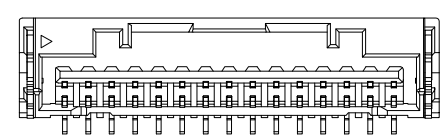

SCONDAR ELECTRONIC LIMITED
 ENGINEER LIU APPROVED

					OPERATION	DRAW	zhong	2019. 10. 12	SCALE	—		
					X. X ±0.30	DESIGN			UNIT	mm		
					X. XX ±0.20				SIZE	A4		
A0					X. XXX ±0.10	CHECK	Lisa	2019. 10. 12	SHEET	1/1	Part No.	SCT1503WVS-xxE1BE113
REV	DATE	MODIFICATION DESCRIPTION		CHANGE	APPROVE	APPROVE			PROJ.	⌀	TITLE:	MX1.5mm XXP PA9T V0 Beige SMT WR Socket