

RoHS

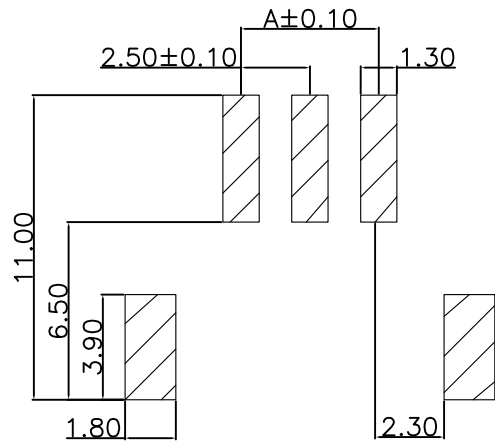
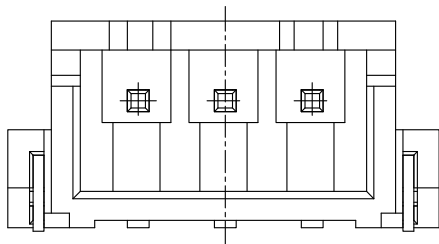
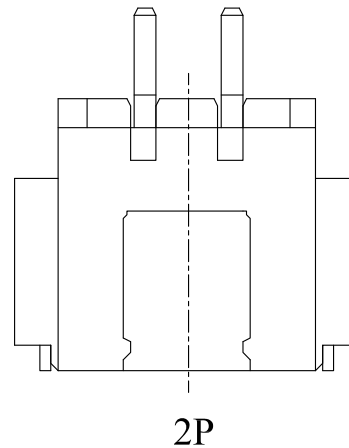
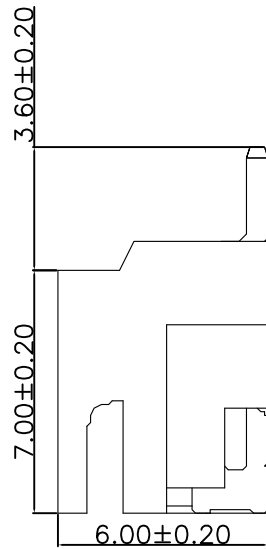
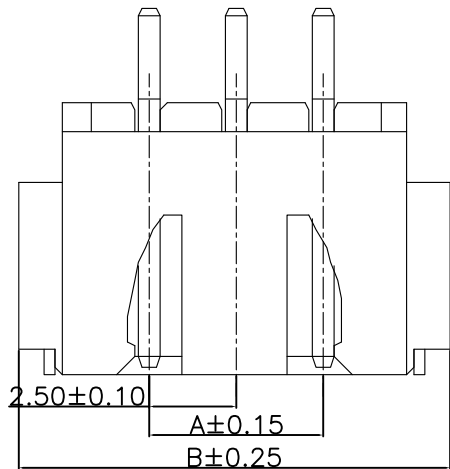

Recommended P.C.B Layout
General Tolerance±0.05

Specification:

- Current Rating: 3A AC/DC
- Voltage Rating: 250V AC/DC
- Insulation Resistance: 1000MΩ Min
- Withstanding Voltage: 1000VAC Min
- Contact resistance: 20mΩ(Max).
- Operation Temperature: -25°C to +85°C
- Applicable Wire: 22-30AWG

Material:

- Insulator (Housing): PA9T (UL94V-0)
- Contacts: Brass
- Solder: Phosphor Bronze
- Color: Beige

Ordering Information

SCT2501WRS - ** E 1 BE 102

No. of Pins See Table Insulation E=PA9T Package I=Tape&Reel Color BE=Beige

东莞市晟凯达电子科技有限公司
工程专用章

受控

11	25.0	32.5			
10	22.5	30.0			
09	20.0	27.5			
08	17.5	25.0			
07	15.0	22.5			
06	12.5	20.0	16	37.5	45.0
05	10.0	17.5	15	35.0	42.5
04	7.5	15.0	14	32.5	40.0
03	5.0	12.5	13	30.0	37.5
02	2.5	10.0	12	27.5	35.0
Poles	A	B	Poles	A	B
	Dimensions			Dimensions	

REV	DATE	MODIFICATION DESCRIPTION	CHANGE	APPROVE	OPERATION	DRAW			SCALE		 SCONDAR ELECTRONIC LIMITED	
					X.X	±0.35			UNIT	mm		
A1	2021.07.06	Changed from SCT2501WR-S-xxP to SCT2501WRS-xxE1BE102			X.XX	±0.25			SIZE	A4		
AO	2006.05.02	NEW			X.XXX	±0.15			SHEET	1/1		
					Angle	± 3'			PROJ.		PART NO.	SCT2501WRS-xxE1BE102
					DIM	TOL	APPROVE	Allen			TITLE:	2.50mm Pitch 90° SMT Wafer Connector