

RoHS

Recommended P.C.B Layout
General Tolerance±0.05

Specification:

- Current Rating: 1A AC/DC
- Voltage Rating: 100V AC/DC
- Insulation Resistance: 1000MΩ Min
- Withstanding Voltage: 800VAC(1Min)
- Contact resistance: 20mΩ(Max).
- Operation Temperature: -25°C to +85°C

Material:

- Insulator (Housing): Nylon 66 (UL94V-0)
- Contacts:Brass Tin Plated
- Color:Brown

Ordering Information

SCT2005WV - ** B 2 BR 131

No. of Pins See Table
Insulation B=PA66
Package 2=Tube
Color BR=Brown

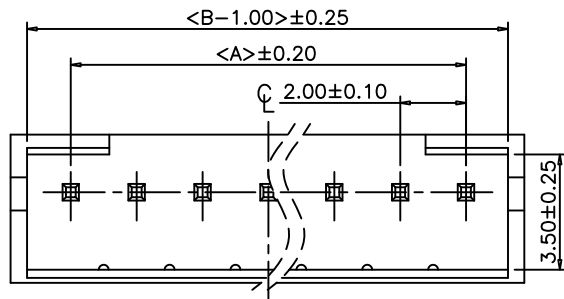
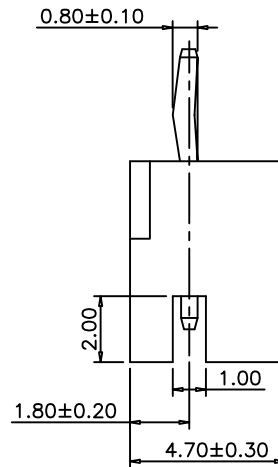
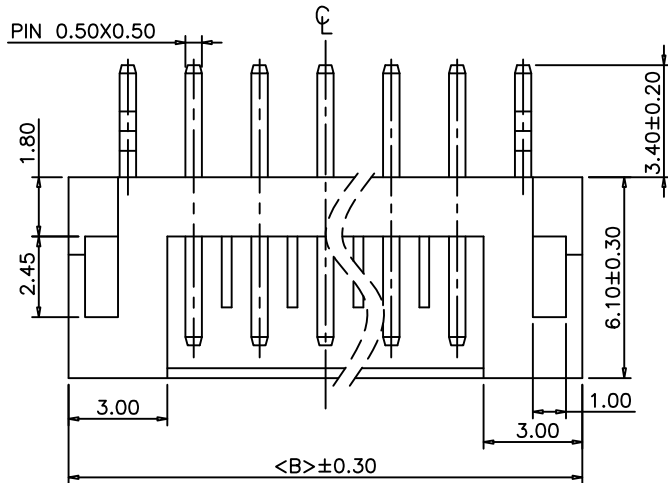
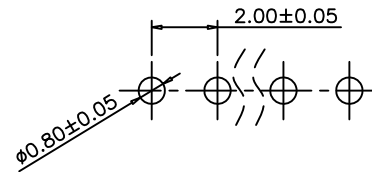

东莞市晟凯达电子科技有限公司
工程专用章

受控

9	16.00	20.00			
8	14.00	18.00	16	30.00	34.00
7	12.00	16.00	15	28.00	32.00
6	10.00	14.00	14	26.00	30.00
5	8.00	12.00	13	24.00	28.00
4	6.00	10.00	12	22.00	26.00
3	4.00	8.00	11	20.00	24.00
2	2.00	6.00	10	18.00	22.00
Poles	A	B	Poles	A	B
	Dimensions			Dimensions	

REV	DATE	MODIFICATION DESCRIPTION	CHANGE	APPROVE	OPERATION	DRAW	Peng	2021.07.10	SCALE		 SCONDAR ELECTRONIC LIMITED	
A1	2021.07.10	Changed from SCT2005WV-xxP to SCT2005WV-xxB2BR131			X.X	±0.35			UNIT	mm		
AO	2015.05.15	NEW			X.XX	±0.25			SIZE	A4		
					X.XXX	±0.15		2021.07.10	SHEET	1/1		
					Angle	± 3'			PROJ.	⊕	PART NO.	SCT2005WV-xxB2BR131
					DIM	TOL		2021.07.10			TITLE:	JAE 2.00mm 180° Wafer