

ROHS

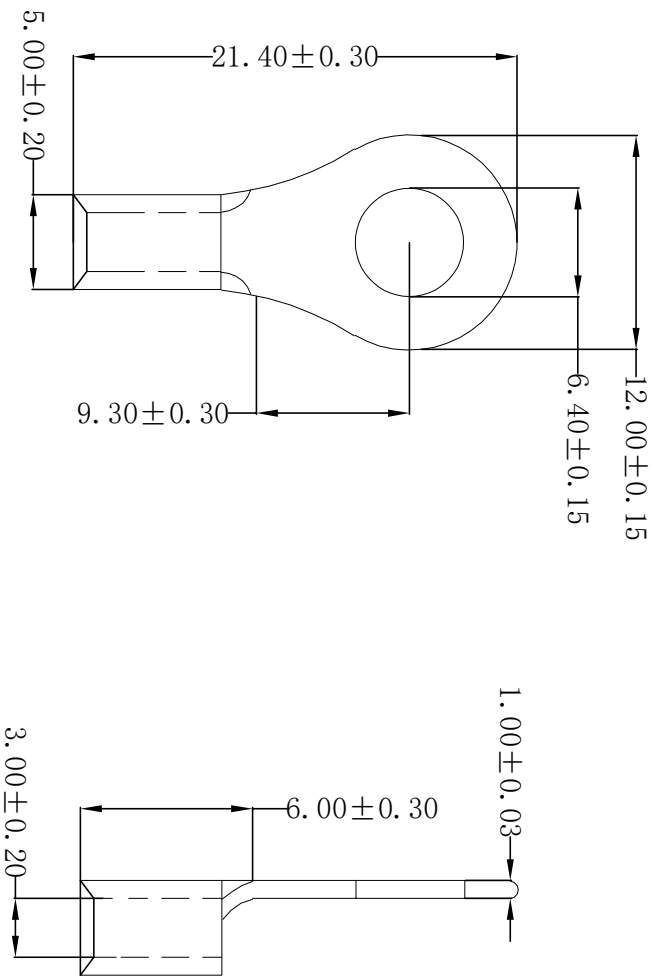

**Technical requirements:**

- Material: Copper (紫铜)
- Applicable wire: 2.50~4.00mm<sup>2</sup>
- Surface treatment: Tin plating
- Plating thickness: 2.5um~5um
- Coating temperature: 120° /2H
- Max Current: 37A
- USA Screw: #1/4
- Appearance: the body should not be scratched or oxidized
- Meet rosh and customer environmental requirements

REV	DATE	MODIFICATION DESCRIPTION	CHANGE	APPROVE	OPERATION	DRAW	YANG	2016.06.06	SCALE	UNIT		SCONDAR ELECTRONIC LIMITED SCTRMB3.5-6141
A0	2016.06.06	NEW			X.X ±0.35	DESIGN			mm			
					X.XX ±0.25	CHECK	Lisa	2016.06.06	SHEET	1/1	PART NO.	Terminal 640R copper Tin plated 2.5~4.0mm <sup>2</sup>
					Angle ±3°	APPROVE			PROJ.		TITLE:	wire, ID:6.40mm OD:12.00mm MPQ=1K/box
1					DIM TOL							