

ROHS

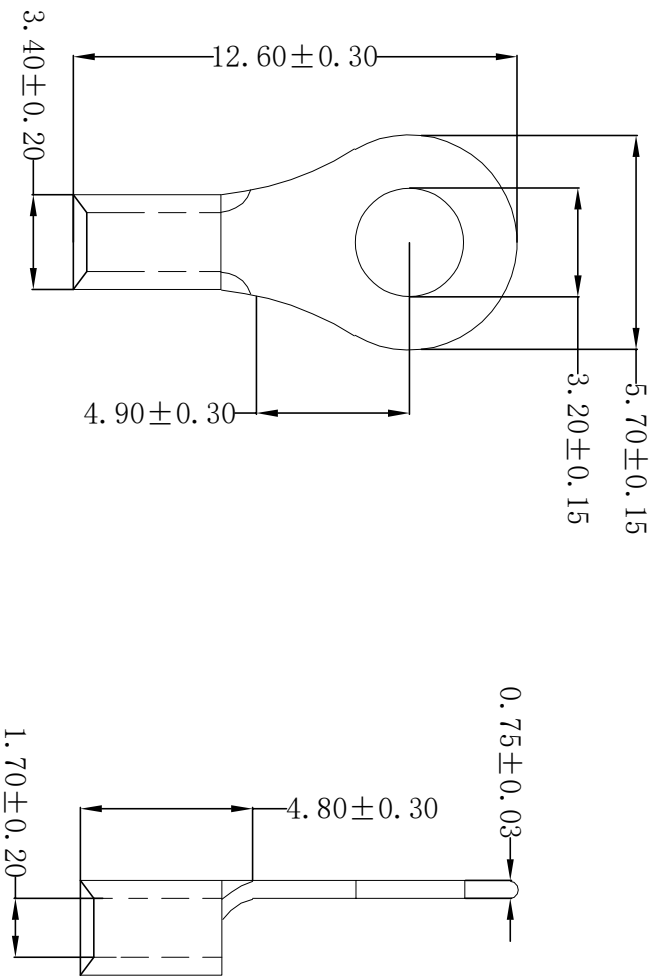

**Technical requirements:**

- Material: Copper (紫铜)
- Applicable wire: 0.50~1.50mm<sup>2</sup>
- Surface treatment: Tin plating
- Plating thickness: 2.5um~5um
- Coating temperature: 120° /2H
- Max Current: 19A
- USA Screw: #4
- Appearance: the body should not be scratched or oxidized
- Meet rosh and customer environmental requirements

REV	DATE	MODIFICATION DESCRIPTION	CHANGE	APPROVE	OPERATION	DRAW	YANG	2016.06.06	SCALE	<p>SCONDAR ELECTRONIC LIMITED</p>	<p>PART NO. SCTRMB1.25-3141</p> <p>Terminal 320R copper Tin plated 0.5~1.5mm<sup>2</sup> wire, ID:3.20mm OD:5.70mm</p>
A0	2016.06.06	NEW			X.X ±0.35	DESIGN		—			
					X.XX ±0.25	CHECK	Lisa	mm			
					X.XXX ±0.15	APPROVE		A4	SIZE		
					Angle ±3°			1/1	SHEET		
					DIM TOL			PROJ.	TITLE:		