

RoHS

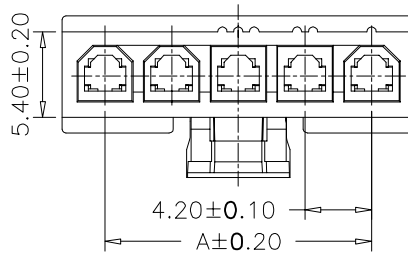
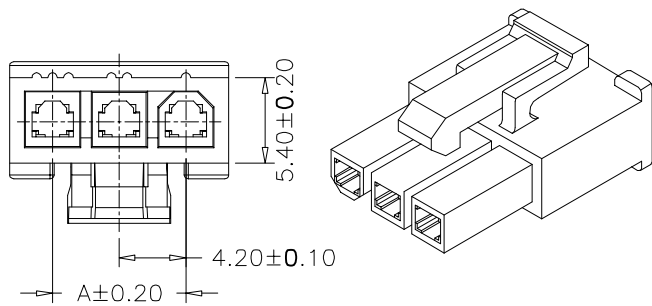

受控

Specification:

- Current Rating: 9A AC/DC
- Voltage Rating: 600V AC/DC
- Insulation Resistance: 1000MΩ Min
- Withstanding Voltage: 1500VAC(1Min)
- Operation Temperature: -25°C to +85°C
- Contact resistance: 20mΩ(Max)

Material:

- Insulator (Housing): Nylon 66 (UL94V-2)
- Color: Natural

Ordering Information

SCT4201FH - \*\* C NA 119

No. of Pins  
02-06Pin

Insulation  
C=PA66 V2

Color  
NA=Natural

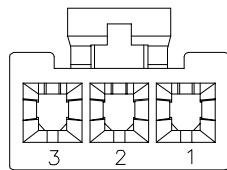
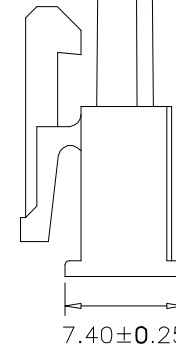
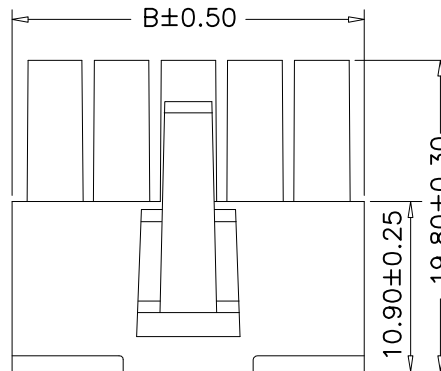
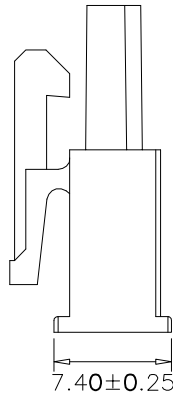
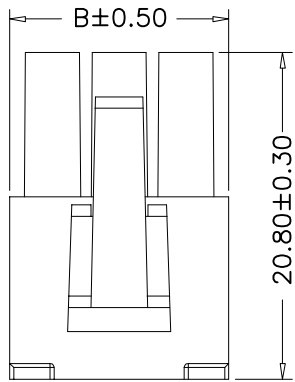

03P

东莞市晟凯达电子科技有限公司  
工程专用章

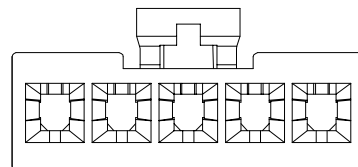

02P,04P,05P,06P

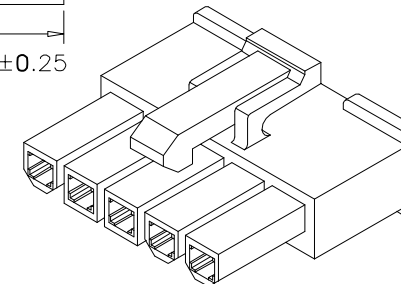

6	21.00	26.40
5	16.80	22.20
4	12.60	18.00
3	8.40	13.80
2	4.20	9.60
Poles	A	B
	Dimensions	

					OPERATION	DRAW	Peng	2006.05.02	SCALE	-	 SCONDAR ELECTRONIC LIMITED
					X.X ±0.35	DESIGN			UNIT	mm	
					X.XX ±0.25	CHECK			SIZE	A4	
					X.XXX ±0.15	APPROVE			SHEET	1/1	
A0	2006.05.02	NEW			Angle ± 3'				PART NO.	SCT4201MH-xxCNA119	
REV	DATE	MODIFICATION DESCRIPTION	CHANGE	APPROVE	DIM TOL	APPROVE			PROJ.	TITLE:	MX 4.20mm Pitch Male Housing Connector