

RoHS

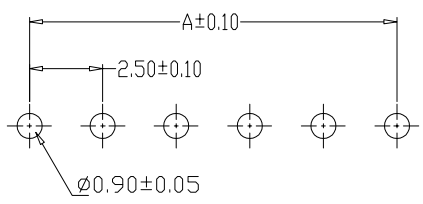
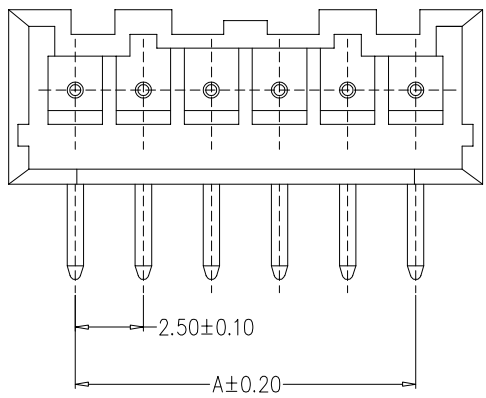
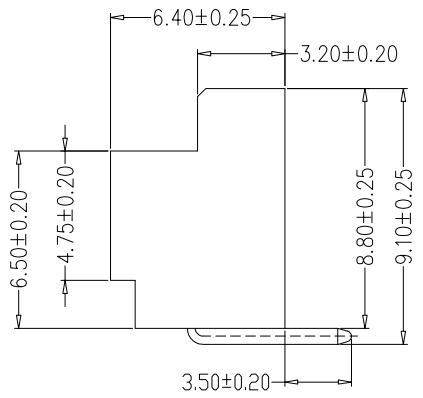
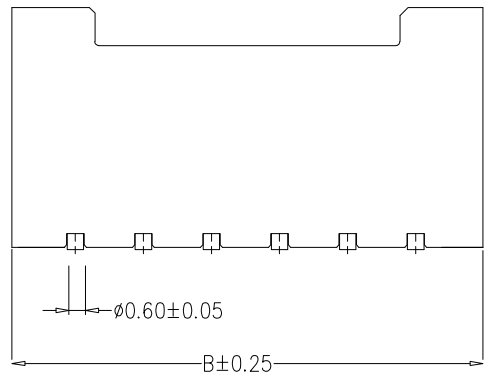

PCB LAYOUT

Specification:

- Current Rating: 3A AC/DC
  - Voltage Rating: 250V AC/DC
  - Insulation Resistance: 1000MΩ Min
  - Withstanding Voltage: 1000VAC(1Min)
  - Contact resistance: 10mΩ (Max).
  - Operation Temperature: -25°C to +85°C
- Material:
- Insulator (Housing): PA46 (UL94V-0)
  - Color: Beige
  - Contacts: Brass/Tin Plated

Ordering Information

SCT2518WR - xx G 0 BE 182

No. of Pins See Table  
Insulation G=PA46 V0  
Package 0=PE Bag  
Color BE=Beige

Dimensions		Part NO	PIN
A	B		
2.50	7.50	SCT2518WR-02GOBE182	2
5.00	10.00	SCT2518WR-03GOBE182	3
7.50	12.50	SCT2518WR-04GOBE182	4
10.00	15.00	SCT2518WR-05GOBE182	5
12.50	17.50	SCT2518WR-06GOBE182	6
15.00	20.00	SCT2518WR-07GOBE182	7
17.50	22.50	SCT2518WR-08GOBE182	8
20.00	25.00	SCT2518WR-09GOBE182	9
22.50	27.50	SCT2518WR-10GOBE182	10
25.00	30.00	SCT2518WR-11GOBE182	11
27.50	32.50	SCT2518WR-12GOBE182	12
47.50	52.50	SCT2518WR-20GOBE182	20

SCONDAR ELECTRONIC LIMITED  
ENGINEER LIU APPROVED



SCONDAR ELECTRONIC LIMITED

AO	DATE	MODIFICATION DESCRIPTION	CHANGE	APPROVE	OPERATION	DRAW	Zhong	2020.08.12	SCALE	—
REV	DATE	MODIFICATION DESCRIPTION	CHANGE	APPROVE	X.X ±0.30	DESIGN			UNIT	mm
					X.XX ±0.20	CHECK	Lisa	2020.08.12	SIZE	A4
					X.XXX ±0.10	APPROVE			SHEET	1/1 Part No.
					Angle ±3°				PROJ.	⊕
					DIM TOL				TITLE:	XA2.5mm DIP WR PA46 V0 XXPin BE Male Socket Bag