

RoHS

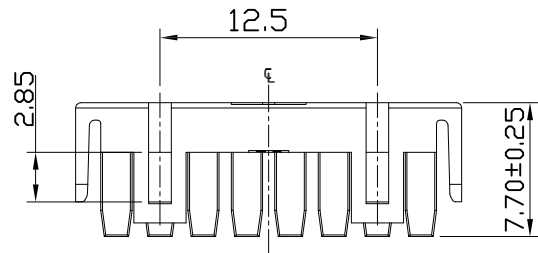

8P-15P

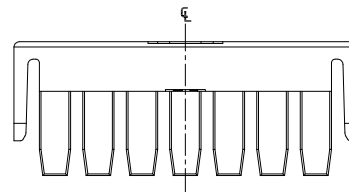

2P-7P

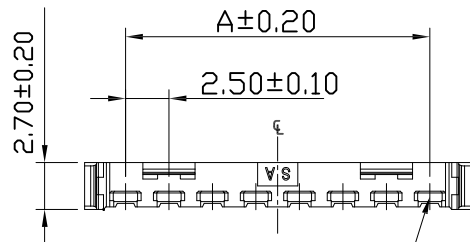

Circuit 1

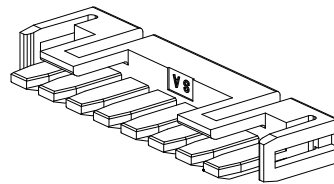
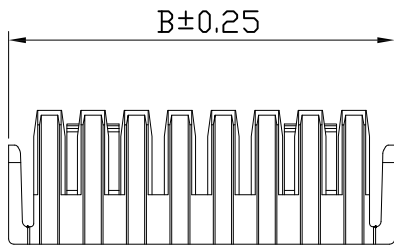
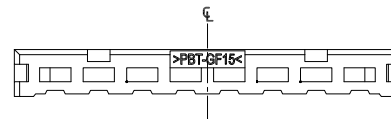
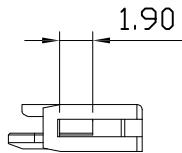

Ordering Information

SCT2516HP-XP-***

1 2

1.Part NO:

2.Color:

(Blank):Gray

Bk:Black

SPECIFICATIONS

Current Rating: 5A AC DC (Max)

voltage Rating:250V AC DC(Max)

Temperature Range:-40°C--+105°C

Contact Resistance: 20Ω Max

Insulation Resistance: 1000V Ac/minute

Material:PBT+15%GF,UL94V-0(Gray)

Ordering Information & Dimension

Part NO	Dimension (mm)	
	A	B
SCT2516HP-2P	2.50	7.20
SCT2516HP-3P	5.00	9.70
SCT2516HP-4P	7.50	12.20
SCT2516HP-5P	10.00	14.70
SCT2516HP-6P	12.50	17.20
SCT2516HP-7P	15.00	19.70
SCT2516HP-8P	17.50	22.20
SCT2516HP-9P	20.00	24.70
SCT2516HP-10P	22.50	27.20
SCT2516HP-11P	25.00	29.70
SCT2516HP-12P	27.50	32.20
SCT2516HP-13P	30.00	34.70
SCT2516HP-14P	32.50	37.20
SCT2516HP-15P	35.00	39.70

REV	DATE	MODIFICATION DESCRIPTION	CHANGE	APPROVE	OPERATION	DRAW	SCALE	UNIT	SIZE	SHEET	PROJ.	TITLE:
AO	2020.07.06	NEW			X.X ±0.35	Yang	2020.06.08	-	mm	1/1		
					X.XX ±0.25				A4			
					X.XXX ±0.15	Lisa.L	2020.06.08					
					Angle ± 3'							
					DIM TOL							



PART NO. SCT2516HP-xxGY136
 PROJ. TITLE: MX51163 2.5mm housing Slip