

RoHS

Recommended P.C.B Layout
General Tolerance±0.05

Specification:

- Current Rating: 3A AC/DC
- Voltage Rating: 250V AC/DC
- Insulation Resistance: 1000MΩ Min
- Withstanding Voltage: 1000VAC Min
- Contact resistance: 20mΩ(Max).
- Operation Temperature: -25°C to +85°C

Material:

- Insulator (Housing): PA66 (UL94V-0)
- Contacts: Brass
- Solder: Tin Plated
- Color: Brown

Ordering Information

SCT2504WV - ** B 0 BN 102

No. of Pins See Table
Insulation B=PA66 V0
Package 0=PE Bag
Color BN=Brown WT=White

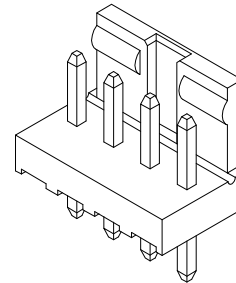
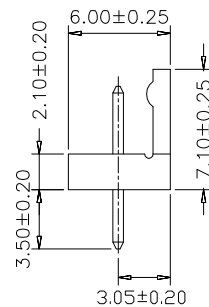
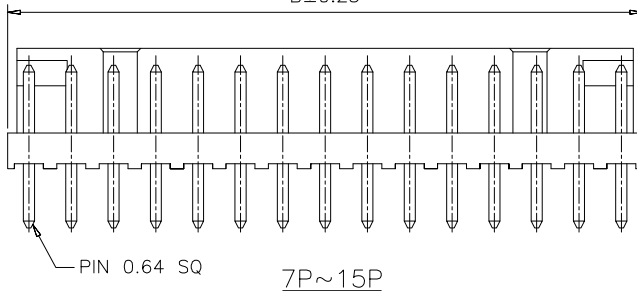
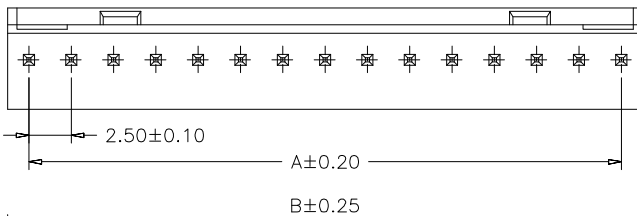
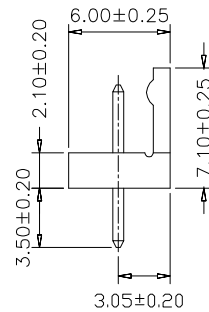
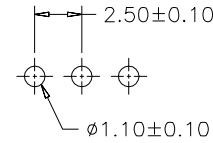
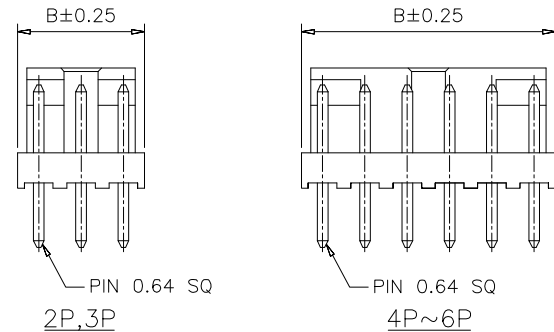
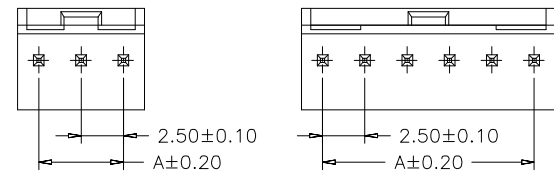

10	22.50	25.00			
9	20.00	22.50			
8	17.50	20.00			
7	15.00	17.50			
6	12.50	15.00	15	35.00	37.50
5	10.00	12.50	14	32.50	35.00
4	7.50	10.00	13	30.00	32.50
3	5.00	7.50	12	27.50	30.00
2	2.50	5.00	11	25.00	27.50
Poles	A		Poles	B	
	Dimensions			Dimensions	

REV	DATE	MODIFICATION DESCRIPTION	CHANGE	APPROVE	OPERATION	DRAW	Peng	2021.07.06	SCALE	-	 SCONDAR ELECTRONIC LIMITED
A1	2021.07.06	Changed from SCT2504WV-xxP to SCT2504WV-xxB0BN102			X.X	±0.35			UNIT	mm	
AO	2006.05.02	NEW			X.XX	±0.25			SIZE	A4	
					X.XXX	±0.15			SHEET	1/1	
					Angle	± 3'			PART NO.	SCT2504WV-xxB0BN102	
					DIM	TOL			PROJ.	 TITLE:	JAE 2.50mm Pitch 180° Wafer Connector