

RoHS

Recommended P.C.B Layout
General Tolerance ± 0.05

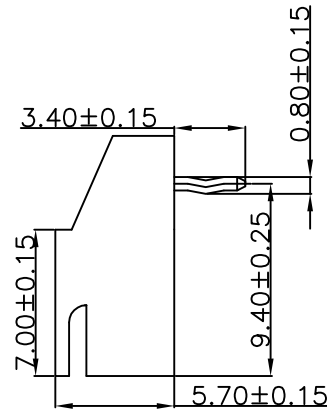
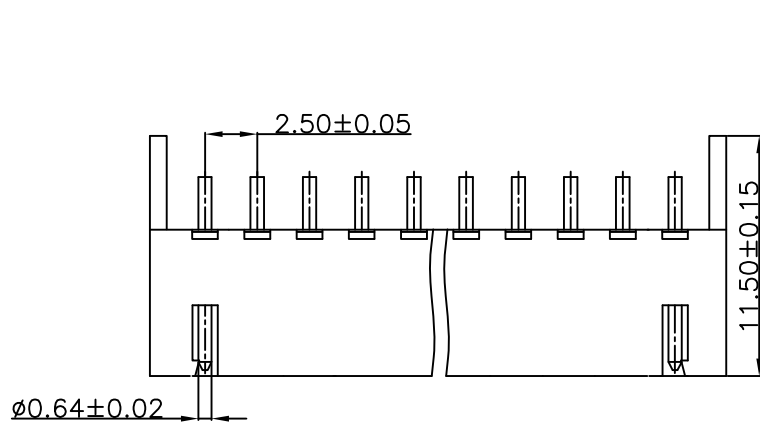
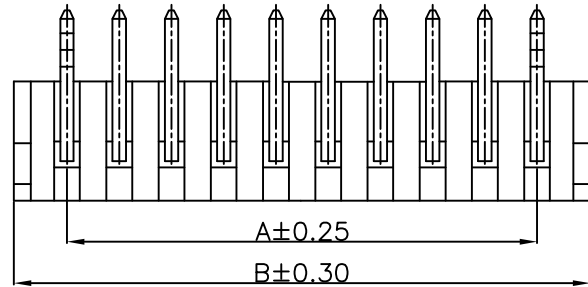
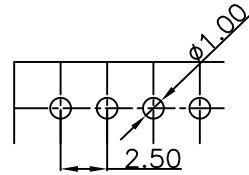

Specification:

- Current Rating: 3A AC/DC
- Voltage Rating: 250V AC/DC
- Insulation Resistance: 1000M Ω Min
- Withstanding Voltage: 1000VAC(1Min)
- Contact resistance: 10m Ω (Max).
- Operation Temperature: -25 $^{\circ}$ C to +85 $^{\circ}$ C

Material:

- Insulator (Housing): Nylon 66 (UL94V-0)
- Contacts: Brass Tin Plated
- Color: White

Ordering Information

SCT2501WR - ** B 0 WT 108

No. of Pins See Table
Insulation B=PA66
Package 0=PE Bag
Color WT=White

11	25.00	30.10			
10	22.50	27.60	20	47.50	52.60
9	20.00	25.10	19	45.00	50.10
8	17.50	22.60	18	42.50	47.60
7	15.00	20.10	17	40.00	45.10
6	12.50	17.60	16	37.50	42.60
5	10.00	15.10	15	35.00	40.10
4	7.50	12.60	14	32.50	37.60
3	5.00	10.10	13	30.00	35.10
2	2.50	7.60	12	27.50	32.60
Poles	A	B	Poles	A	B
	Dimensions			Dimensions	

REV	DATE	MODIFICATION DESCRIPTION	CHANGE	APPROVE	OPERATION	DRAW	Peng	2021.07.06	SCALE	-	 SCONDAR ELECTRONIC LIMITED	
A1	2021.07.06	Changed from SCT2501WR-xxP to SCT2501WR-xxBOWT108			X.X	DESIGN			UNIT	mm		
AO	2009.10.15	NEW			X.XX	CHECK	Lisa	2021.07.06	SIZE	A4		
					X.XXX	APPROVE	Allen	2021.07.06	SHEET	1/1		
					Angle				PROJ.	1/1	PART NO.	SCT2501WR-xxBOWT108
					DIM						TITLE:	XH 2.50mm 90° Wafer