

RoHS

Recommended P.C.B Layout
General Tolerance ± 0.05

Specification:

- Current Rating: 1A AC/DC
- Voltage Rating: 150V AC/DC
- Insulation Resistance: 100M Ω Min
- Withstanding Voltage: 500VAC(1Min)
- Contact resistance: 20m Ω (Max).
- Operation Temperature: -40 $^{\circ}$ C to +85 $^{\circ}$ C

Material:

- Insulator (Housing): Nylon 9T (UL94V-0)
- Contacts: Phosphor.Bronze
- Solder Tabs: Tin Plated
- Color: Beige

Ordering Information

SCT1258WRS - ** E 1 BE 101

No.of Pins See Table Insulation E=PA9T Package 1=Tape&Reel Color BE=Beige

10	11.25	13.85	15.75				
9	10.00	12.60	14.50				
8	8.75	11.35	13.25				
7	7.50	10.10	12.00				
6	6.25	8.85	10.75	15	17.50	20.10	22.00
5	5.00	7.60	9.50	14	16.25	18.85	20.75
4	3.75	6.35	8.25	13	15.00	17.60	19.50
3	2.50	5.10	7.00	12	13.75	16.35	18.25
2	1.25	3.85	5.75	11	12.50	15.10	17.00
Poles	A	B	C	Poles	A	B	C
	Dimensions				Dimensions		

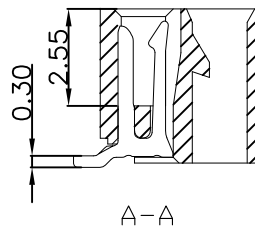
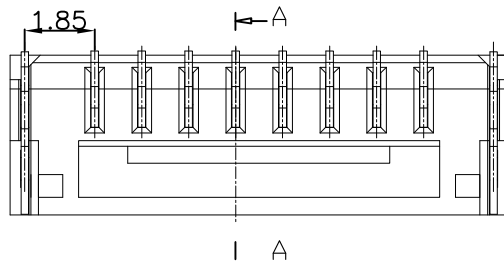
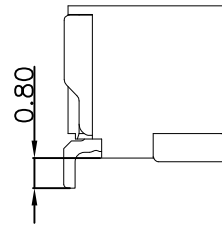
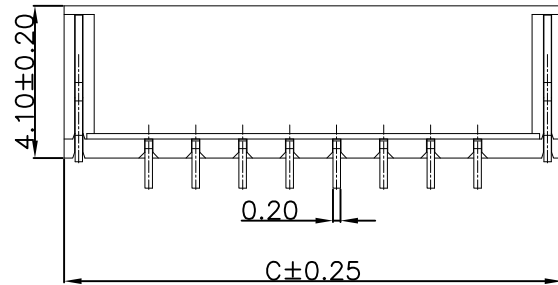
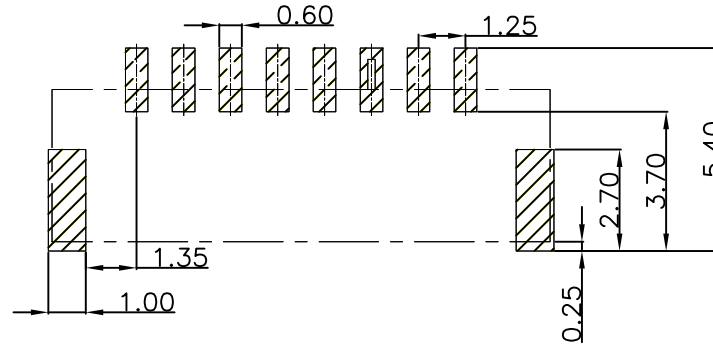
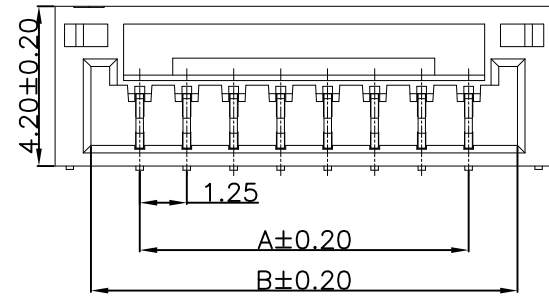

REV	DATE	MODIFICATION DESCRIPTION	CHANGE	APPROVE	OPERATION	DRAW	Peng	2021.07.02	SCALE	UNIT	mm	SCONDAR ELECTRONIC LIMITED		
A1	2021.07.02	Changed from SCT1258WR-S-xxP to SCT1258WRS-xxE1BE101			X.X	DESIGN				mm			SCONDAR ELECTRONIC LIMITED	
AO	2010.08.02	NEW			X.XX	CHECK	Lisa	2021.07.02		A4				
					X.XXX	CHECK								
					Angle	APPROVE	Allen	2021.07.02		1/1		PART NO.	SCT1258WRS-xxE1BE101	⚠
					DIM	APPROVE				PROJ.		TITLE:	GH 1.25mm 90° SMT Wafer	

SCONDAR
SCONDAR ELECTRONIC LIMITED

PART NO. SCT1258WRS-xxE1BE101 ⚠

TITLE: GH 1.25mm 90° SMT Wafer